

- 3** Connect the end of the cable marked "zip" to the Zip connector on the back of your drive. (If the connector does not go on easily, try turning it over. **Tighten** all connector screws.)

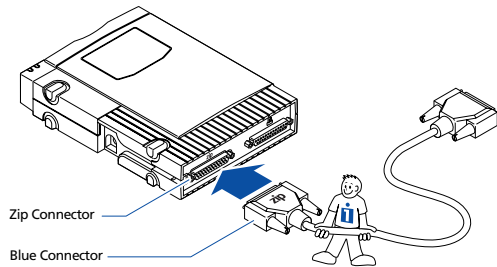

- 4** Connect the other end of the cable to your computer's parallel port (printer port). (If a printer is connected to the only parallel port, disconnect it.)

The parallel port may be marked with a printer icon . A parallel port may also be labeled "Printer" or not marked at all. Check your computer Owner's Manual if you are unable to locate your computer's parallel port.

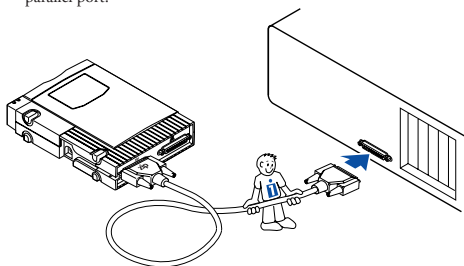

- 5** **OPTIONAL:** You can connect a printer to the Zip drive using a standard printer cable.

The Zip drive must have power in order for the printer pass-through feature to work.

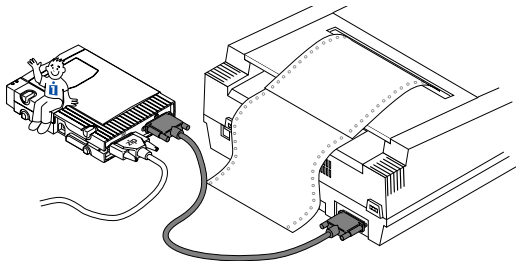

■ **NOTE:** If you use other peripherals or software keys (dongles) that hook to the parallel port, refer to the information under #8 in the "Troubleshooting" section of the Zip User's Guide. ■

- 6** Turn your computer ON, and connect the Zip drive's power supply. (The power cord fits in the groove on the side of the drive.)

Always turn on power to your computer before or at the same time as you supply power to your parallel port Zip drive. Iomega recommends using a power strip to turn on all your devices at the same time. Power must be applied to the Zip drive before DOS begins to load.

WARNING Use only an approved Iomega Zip power supply. Other power supplies may damage your Zip drive. ■

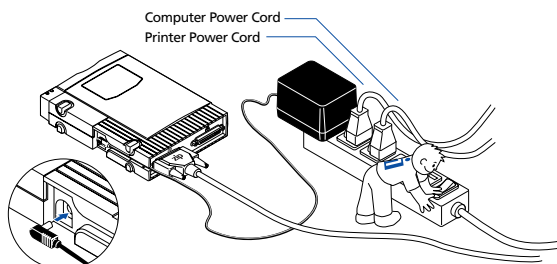

To make it easier to move your Zip drive between home and work, you may want to purchase an extra power supply, cable, and carrying case. Call 1-800-MY-STUFF to order Zip accessories.

- 7** Check the green power light to make sure the Zip drive power connection is OK.

If the power light does not come on, refer to the "Troubleshooting" section in your Zip User's Guide.

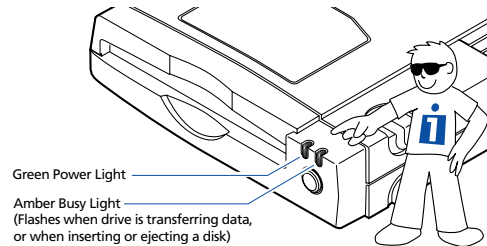

- 8** Insert the 100MB "tools" disk into the Zip drive.

Always make sure the green power light is on before inserting (or ejecting) a Zip disk. When you insert a Zip disk, the amber busy light on the Zip drive will flash momentarily.

CAUTION Never put anything except Zip disks into the Zip drive as this could damage your drive. ■

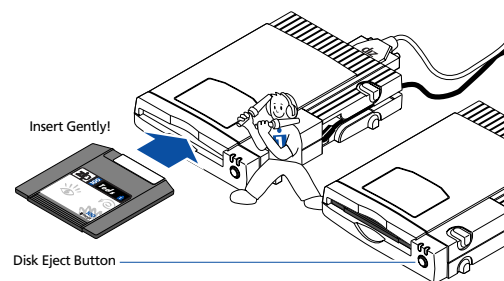

- 9** Insert the Install diskette for Windows/DOS into the computer's floppy drive.

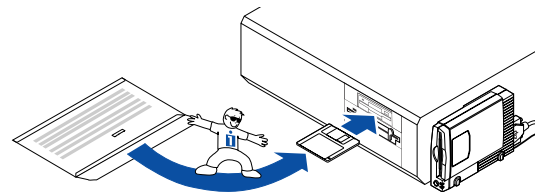

- 10** Start the Setup program as described below and follow the screen instructions to install your Zip Tools software.

Windows 95 Users: Open *My Computer* and double click on the floppy drive icon to open a window for the Install diskette. Double click on the **Setup** icon to install Tools 95 on your system.

Windows 3.1 Users: Start Windows. In the Windows Program Manager, select the File menu and choose **Run**. In the Command Line box, type **a:setup** if the Install diskette is in drive a: (or **b:setup** if it is in drive b:), then click **OK** or press the Enter key.

DOS Users: Run **GUEST.EXE** from the DOS prompt for the Install diskette, then run **INSTALL.EXE** from the **DOSSTUFF** directory on the Zip "tools" disk. After the software installation is complete, run **RECLAIM.EXE** from the **DOSSTUFF** directory. If you need detailed instructions, refer to **MANUALEXE** on the Install diskette.

If you need help, refer to "Troubleshooting" in the *Zip User's Guide*. The electronic manual (**MANUAL.EXE**) located on the Install diskette also includes problem solving information for software installations under Windows 95, Windows 3.1, and DOS.



Congratulations! When the software installation is complete, your Zip drive will be ready to use.

Use your Zip drive just like any other drive on your system. Your Zip drive will have its own drive letter, and you can store and copy files to and from the Zip drive using the same methods you use for your other drives. For additional information on using your new drive and Zip tools software, refer to the Zip User's Guide.